

1 GROUND FLOOR RCP  
1:100

NOTES

FOR MECHANICAL, ELECTRICAL AND FIRE SERVICES FITTING POSITIONS REFER TO CARDNO ENGINEERING DRAWINGS AS FOLLOWS:  
80816048-ME-1001 REV.3  
80816048-EL-0001 REV.3  
80816048-FP-0001 REV.C

**ELECTRICAL LEGEND**

- MD-360 PIR MOVEMENT DETECTOR
- LUM1- FLUORESCENT LUMINAIRE
- LUM2- RECESSED DOWNLIGHT
- EXIT- VANDAL RESISTANT LED EXIT SIGN
- EXPOSED SOFFIT
- 2400 mm HIGH C.PNT-02 PAINT ON C.F.C-01 F.C. SHEET CEILING, ON RIGID FRAMING SYSTEM

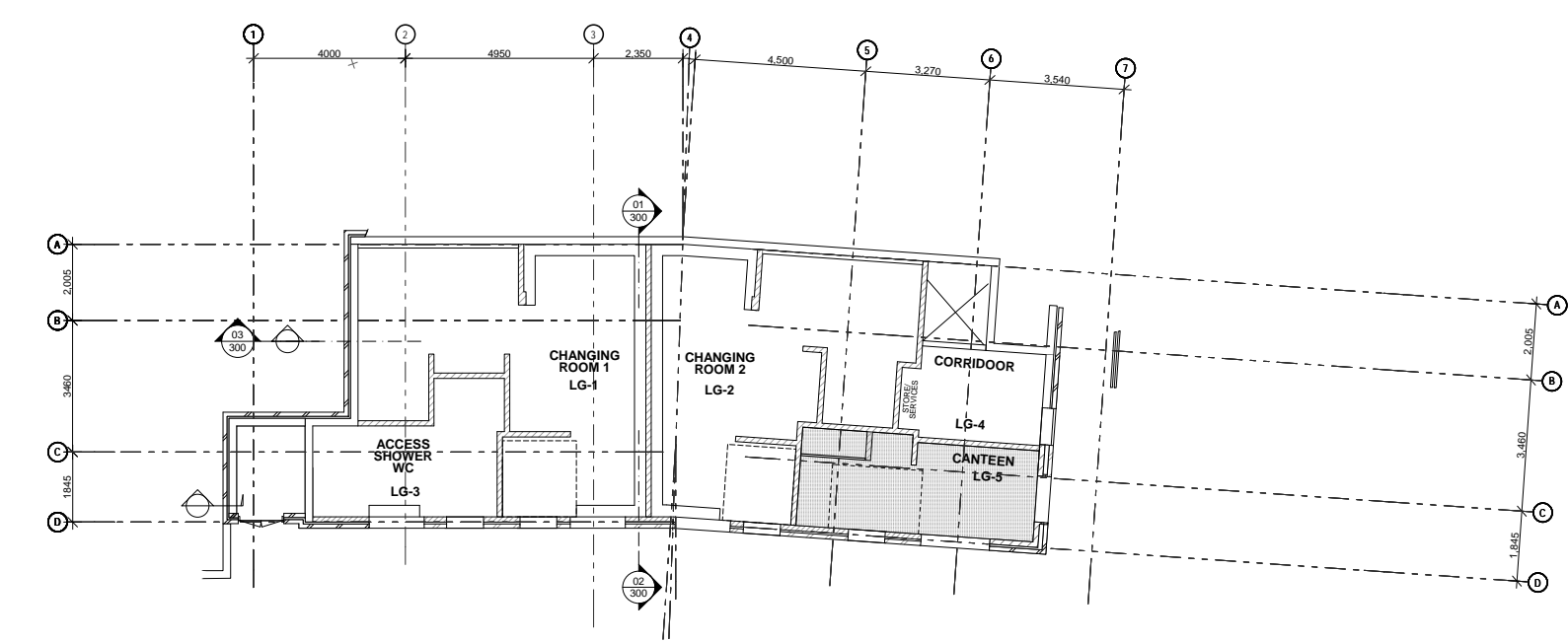

1 LOWER GROUND FLOOR RCP  
1:100

**PROJECT:**  
COMMUNITY FACILITY AND AMENITIES BUILDING

**FOR:**  
BRIARS SPORTING CLUB

**AT:**  
ROTHWELL PARK, CONCORD, NSW

This drawing is protected under the Copyright Act 1968 and is the copyright of Figgis and Jefferson Architects. Do not reproduce, modify or transmit this drawing without the permission of Figgis and Jefferson Architects.

Do not scale this drawing. Use figured dimensions only. Confirm all dimensions and levels on site prior to commencement of any work, preparation of shop drawings or fabrication of components.

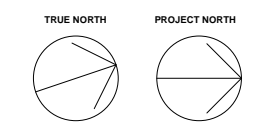

**DRAWING TITLE:**  
REFLECTED CEILING PLAN

**ARCHITECT:** SF  
**DRAWN:** DR/PM

**LAST PRINTED:**  
20/12/2016

**DRAWING NO.:** 3557 TN 170  
**ISSUE:** F

**SCALE:** 0m 1 2 3 4 5 @A1



Figgis + Jefferson Pty Ltd 220 Willoughby Road Crows Nest NSW 2058  
T 02 9438 5555 F 02 9439 5163 E studio@figgis.com.au www.figgis.com.au  
ACN 002 895 505 NSW Architects Registration Board Nominated Architect Stephen Figgis 1988

figgis + jefferson  
ARCHITECTS